

TRACT OF LAND IN U.S. SURVEY 2010 & SECTION 35, TOWNSHIP 44 NORTH,
RANGE 3 EAST,
CITY OF EUREKA, ST. LOUIS COUNTY, MISSOURI (P.B. 365, PGS. 558–563)

NOTE:
ALL SANITARY SERVICE LATERALS UNLESS OTHERWISE NOTED SHALL HAVE A BACKFLOW PREVENTER INSTALLED BY THE PLUMBING CONTRACTOR DURING THE CONSTRUCTION OF THE RESIDENCE ON A LOT AND SHALL BE COVERED BY THE BUILDING PERMIT ISSUED BY THE CITY AND/OR COUNTY FOR THE GIVEN LOT.

(IN FEET)
1 inch = 20 ft.

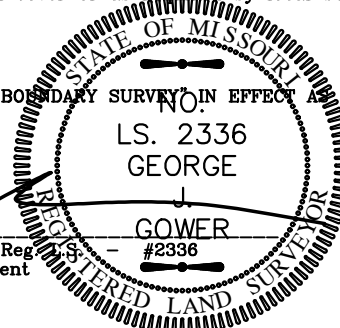

	P.P.	FDN.	FNL.
DRAWN	S.S.		
CHECKED			